

MAP FOR ORDER

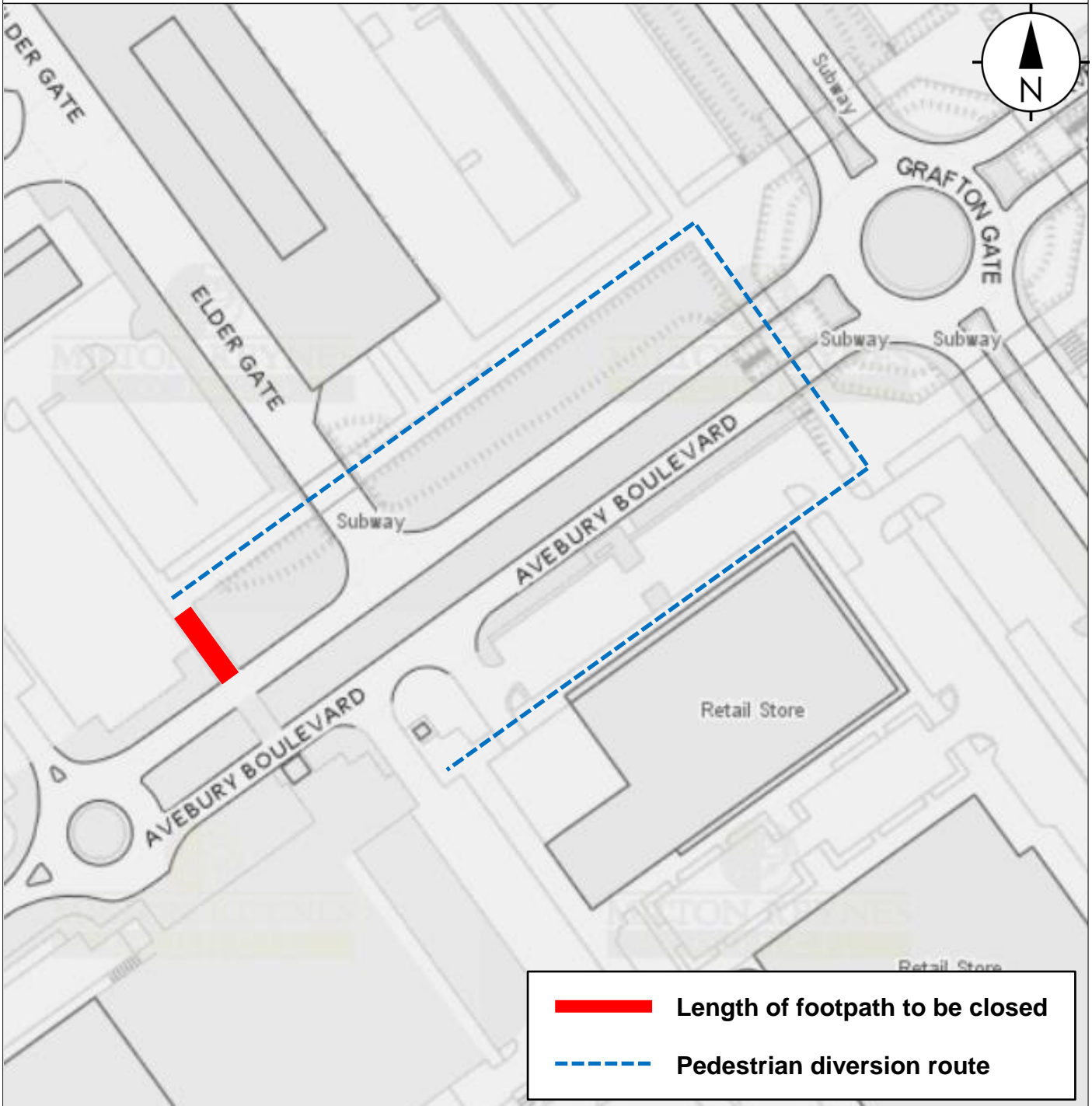

Map referred to in the Council of the Borough of Milton Keynes (Avebury Boulevard, Central Milton Keynes) (Temporary Footpath Closure) Order 2019.

This map is not to scale

The common seal of the Council of the Borough of Milton Keynes was hereunto affixed in the presence of:

.....
HEAD OF LEGAL SERVICES